

Appendix F-1

Webster-Pembroke Request to New Hampshire Division of Historical Resources for
Project Review
dtd October 10, 2013

Please mail the completed form and required material to:

New Hampshire Division of Historical Resources
State Historic Preservation Office
Attention: Review & Compliance
19 Pillsbury Street, Concord, NH 03301-3570

DHR Use Only

R&C # _____

Log In Date ____/____/____

Response Date ____/____/____

Sent Date ____/____/____

Request for Project Review by the New Hampshire Division of Historical Resources

☒ This is a new submittal

☐ This is additional information relating to DHR Review & Compliance (R&C) #:

GENERAL PROJECT INFORMATION

Project Title Webster Pembroke Hydroelectric Facility

Project Location 100-2 Main Street on the Suncook River

City/Town Suncook Tax Map VW Lot # 243-1

NH State Plane - Feet Geographic Coordinates: Easting 17378 Northing 70063.734
(See RPR Instructions and R&C FAQs for guidance.)

Lead Federal Agency and Contact (if applicable) Federal Energy Regulatory Commission
(Agency providing funds, licenses, or permits)

Permit Type and Permit or Job Reference # FERC Exempt No. 3185

State Agency and Contact (if applicable)

Permit Type and Permit or Job Reference #

APPLICANT INFORMATION

Applicant Name Essex Power Services, Inc.

Mailing Address 55 Union Street, 4th Floor Phone Number (617) 367-0032

City Boston State MA Zip 02108 Email sjh@essexhydro.com

CONTACT PERSON TO RECEIVE RESPONSE

Name/Company Essex Power Services, Inc.

Mailing Address 55 Union Street, 4th Floor Phone Number 6173670032

City Boston State MA Zip 02108 Email sjh@essexhydro.com

This form is updated periodically. Please download the current form at www.nh.gov/nhdhr/review. Please refer to the Request for Project Review Instructions for direction on completing this form. Submit one copy of this project review form for each project for which review is requested. Include a self-addressed stamped envelope to expedite review response. Project submissions will not be accepted via facsimile or e-mail. This form is required. Review request form must be complete for review to begin. Incomplete forms will be sent back to the applicant without comment. Please be aware that this form may only initiate consultation. For some projects, additional information will be needed to complete the Section 106 review. All items and supporting documentation submitted with a review request, including photographs and publications, will be retained by the DHR as part of its review records. Items to be kept confidential should be clearly identified. For questions regarding the DHR review process and the DHR's role in it, please visit our website at: www.nh.gov/nhdhr/review or contact the R&C Specialist at christina.st.louis@dcrr.nh.gov or 603.271.3558.

PROJECTS CANNOT BE PROCESSED WITHOUT THIS INFORMATION

Project Boundaries and Description

- ☒ Attach the relevant portion of a 7.5' USGS Map (photocopied or computer-generated) *indicating the defined project boundary. (See RPR Instructions and R&C FAQs for guidance.)*
- ☒ Attach a detailed narrative description of the proposed project.
- ☒ Attach a site plan. The site plan should include the project boundaries and areas of proposed excavation.
- ☒ Attach photos of the project area (overview of project location and area adjacent to project location, and specific areas of proposed impacts and disturbances.) *(Informative photo captions are requested.)*
- ☐ A DHR file review must be conducted to identify properties within or adjacent to the project area. Provide file review results in Table 1 or within project narrative description. *(Blank table forms are available on the DHR website.)*
File review conducted on / / .

Architecture

Are there any buildings, structures (bridges, walls, culverts, etc.) objects, districts or landscapes within the project area? ☒ Yes ☐ No
If no, skip to Archaeology section. If yes, submit all of the following information:

Approximate age(s): 50 years

- ☒ Photographs of *each* resource or streetscape located within the project area, with captions, along with a photo key. (Digital photographs are accepted. All photographs must be clear, crisp and focused.)
- ☐ If the project involves rehabilitation, demolition, additions, or alterations to existing buildings or structures, provide additional photographs showing detailed project work locations. (i.e. Detail photo of windows if window replacement is proposed.)

Archaeology

Does the proposed undertaking involve ground-disturbing activity? ☐ Yes ☒ No
If yes, submit all of the following information:

- ☒ Description of current and previous land use and disturbances.
- ☐ Available information concerning known or suspected archaeological resources within the project area (such as cellar holes, wells, foundations, dams, etc.)

Please note that for many projects an architectural and/or archaeological survey or other additional information may be needed to complete the Section 106 process.

DHR Comment/Finding Recommendation *This Space for Division of Historical Resources Use Only*

☐ Insufficient information to initiate review. ☐ Additional information is needed in order to complete review.

☐ No Potential to cause Effects ☐ No Historic Properties Affected ☐ No Adverse Effect ☐ Adverse Effect

Comments: _____

If plans change or resources are discovered in the course of this project, you must contact the Division of Historical Resources as required by federal law and regulation.

Authorized Signature: _____ Date: _____

Webster Pembroke (FERC Exemption No. 3185) Request for Project Review by the

New Hampshire Division of Historical Resources

Appendix 1 – Detailed Narrative Description of the Project

Webster Pembroke Generating Station



The Webster Pembroke facility is located on the Suncook River near the Town of Pembroke, New Hampshire. The site consists of a 500 foot power canal and a 480 foot penstock leading to a concrete powerhouse housing a single turbine generator. The site was constructed in 1986 and has an installed capacity of 2,600 kilowatts/ The site is connected at 3 phase 34.5kW.

Power Sales

Gregg Falls currently holds an operating agreement for the purpose of power sales and wheeling with the Public Service Company of New Hampshire (PSNH). This facility currently sells power under this agreement to PSNH. Power is sold at the ISO-NE Real Time Hourly Locational Marginal Price (RT LAMP) in the New Hampshire Load Zone.

Webster Pembroke (FERC Exemption No. 3185) Request for Project Review by the

New Hampshire Division of Historical Resources

Appendix 2 – Description of Land Uses

Webster Pembroke Generating Station

Description of Historical and Current Land Uses

The Webster Pembroke facility is located on the Suncook River near the town of Pembroke, New Hampshire. The site was constructed in 1986 and has been used exclusively for the generation of electrical energy.

Appendix 3

Webster Pembroke Hydroelectric Facility Project Maps

Physical Address: 100-2 Main Street
Suncook, NH 03275

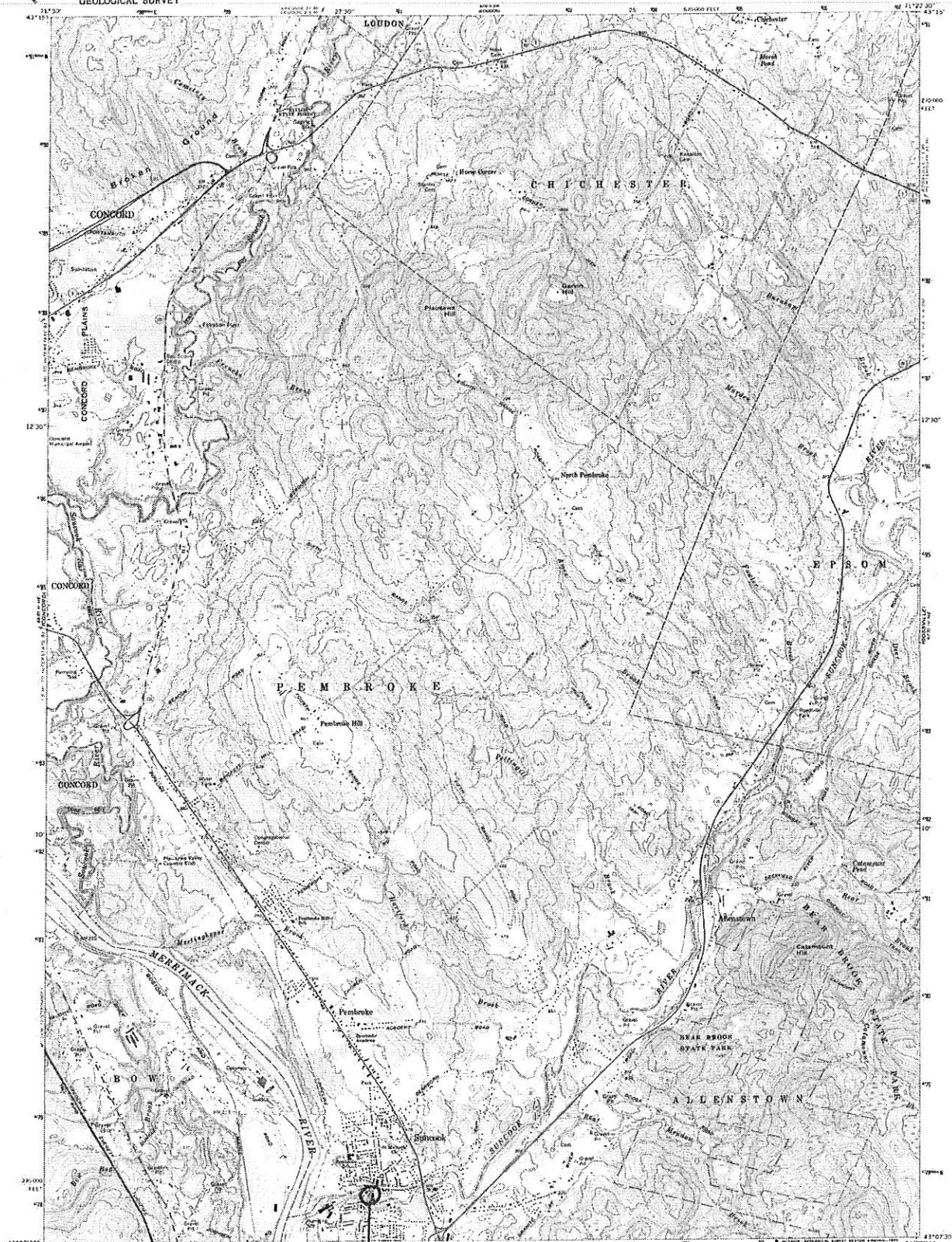

Maped, edited, and published by the Geological Survey
Control by U.S.G.S., N.H.S., and New Hampshire Geological Survey
Topography by photogrammetric methods from aerial
photographs taken 1967. Field checked 1967.
Polyconic projection. 10,000-foot grid ticks based on New Hampshire
coordinate system.
Zone 19, UTM in blue.
1927 North American Datum.
To place on the projected North American Datum 1983,
move the projection lines 8 meters south and
40 meters east as shown by dashed corner ticks.
Fine red dashed lines indicate selected horse and field lines where
priority exists on aerial photography. This information is unchecked
There may be private embeddings within the boundaries of
the National or State reservations shown on this map.

ONE CENT AND TWO-SIXTEEN NORTH
REMARKS: 1. DATE OF SURVEY
2. NAME OF SURVEYOR
3. NAME OF PROJECT
4. NAME OF CLIENT
5. NAME OF CONTRACTOR
6. NAME OF ENGINEER
7. NAME OF ARCHITECT
8. NAME OF LANDSCAPE ARCHITECT
9. NAME OF PLANNING FIRM
10. NAME OF CONSULTANT
11. NAME OF SPECIALIST
12. NAME OF SUBCONTRACTOR
13. NAME OF SUPPLIER
14. NAME OF MANUFACTURER
15. NAME OF DISTRIBUTOR
16. NAME OF RETAILER
17. NAME OF WHOLESALE
18. NAME OF EXPORTER
19. NAME OF IMPORTER
20. NAME OF AGENT
21. NAME OF BROKER
22. NAME OF COMMISSIONER
23. NAME OF MANAGER
24. NAME OF SUPERVISOR
25. NAME OF ASSISTANT
26. NAME OF CLERK
27. NAME OF RECEPTIONIST
28. NAME OF SECURITY GUARD
29. NAME OF JANITOR
30. NAME OF CLEANER
31. NAME OF PAINTER
32. NAME OF CARPENTER
33. NAME OF ELECTRICIAN
34. NAME OF PLUMBER
35. NAME OF ROOFER
36. NAME OF SINKER
37. NAME OF FOUNDRY
38. NAME OF BLACKSMITH
39. NAME OF WELDER
40. NAME OF MILLER
41. NAME OF TANNER
42. NAME OF LEATHERWORKER
43. NAME OF JEWELER
44. NAME OF SILVERSMITH
45. NAME OF GLASSBLASER
46. NAME OF POTTER
47. NAME OF CERAMICIST
48. NAME OF SCULPTOR
49. NAME OF CARVING
50. NAME OF PAINTER

CONTOUR INTERVAL 10 FEET
NATIONAL GEODETIC DATUM OF 1983
SCALE 1:50,000
THIS MAP COMPLETES WITH NATIONAL MAP ACTUALLY STANDARDS
FOR SALE BY U.S. GEOLOGICAL SURVEY
DENVER, COLORADO 80219, OR RESTON, VIRGINIA 22092
FOLDING DESIGNED TOPOGRAPHIC MAPS AND SYMBOLS IS AVAILABLE ON REQUEST

ROAD CLASSIFICATION
Primary highway, all weather. Light duty road, all weather.
Hard surface. Improved surface.
Secondary highway, all weather. Unimproved road, fair or dry
weather.
Hard surface. U.S. Route. State Route.
SUNCOOK, N. H.
NEW HAMPSHIRE
4000'S M.F. 6014
1967
PHOTOREPRODUCED FROM
DMA 8712 IN NW. SERIES 7943

USGS MINOR HISTORICAL MAP
MAR 23 1989
REC'D FILE COPY

Webster-Pembroke hydroelectric
project location

ENGINEERS
SURVEYORS
DESIGNERS

JOHN W. DURGINS ASSOCIATES, INC.
ESTABLISHED 1919

400 DORLAND ROAD
10 WEXFORD SQUARE
ROCHESTER, NH 05601
603-333-1000

NOTE: PARCEL 6 IS SHOWN
FOR REFERENCE ONLY. THIS
PARCEL IS NOT OWNED BY
PEMBROKE ASSOCIATES, INC.
AND IS NOT BEING
ACQUIRED BY THEM.

PARCEL 6 - MAP YW LOT 242
SCALE 1"=100'



TO ALL PARTIES INTERESTED IN THIS PROJECT: THE SURVEYOR HAS BEEN ADVISED BY THE ENGINEER THAT THE PROJECT IS NOT A PUBLIC PROJECT AND THAT THE SURVEYOR IS NOT TO BE RESPONSIBLE FOR THE PROJECT. THE SURVEYOR HAS BEEN ADVISED BY THE ENGINEER THAT THE PROJECT IS NOT A PUBLIC PROJECT AND THAT THE SURVEYOR IS NOT TO BE RESPONSIBLE FOR THE PROJECT.

FILE NO. 33-41
PLAN NO. 50190-4

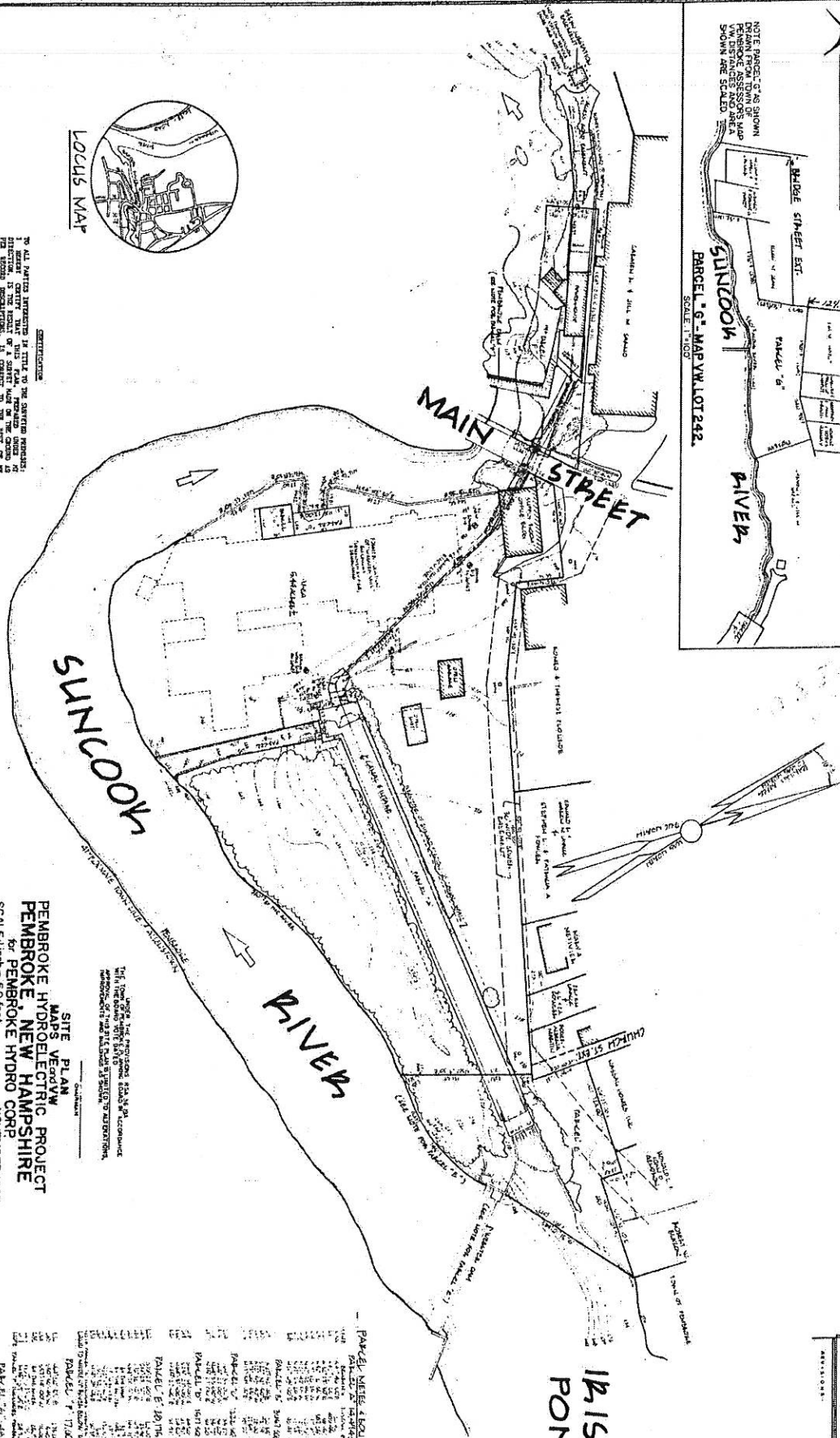

SITE PLAN
PEMBROKE HYDROELECTRIC PROJECT
PEMBROKE, NEW HAMPSHIRE
for PEMBROKE HYDRO CORP.
NOVEMBER 1983
SCALE 1 inch = 50 feet

PARCEL NOTES & EASEMENTS

PARCEL	AREA (AC)	REMARKS
PARCEL 1	17.007 AC	17.007 AC
PARCEL 2	17.007 AC	17.007 AC
PARCEL 3	17.007 AC	17.007 AC
PARCEL 4	17.007 AC	17.007 AC
PARCEL 5	17.007 AC	17.007 AC
PARCEL 6	17.007 AC	17.007 AC
PARCEL 7	17.007 AC	17.007 AC
PARCEL 8	17.007 AC	17.007 AC
PARCEL 9	17.007 AC	17.007 AC
PARCEL 10	17.007 AC	17.007 AC
PARCEL 11	17.007 AC	17.007 AC
PARCEL 12	17.007 AC	17.007 AC
PARCEL 13	17.007 AC	17.007 AC
PARCEL 14	17.007 AC	17.007 AC
PARCEL 15	17.007 AC	17.007 AC
PARCEL 16	17.007 AC	17.007 AC
PARCEL 17	17.007 AC	17.007 AC
PARCEL 18	17.007 AC	17.007 AC
PARCEL 19	17.007 AC	17.007 AC
PARCEL 20	17.007 AC	17.007 AC
PARCEL 21	17.007 AC	17.007 AC
PARCEL 22	17.007 AC	17.007 AC
PARCEL 23	17.007 AC	17.007 AC
PARCEL 24	17.007 AC	17.007 AC
PARCEL 25	17.007 AC	17.007 AC
PARCEL 26	17.007 AC	17.007 AC
PARCEL 27	17.007 AC	17.007 AC
PARCEL 28	17.007 AC	17.007 AC
PARCEL 29	17.007 AC	17.007 AC
PARCEL 30	17.007 AC	17.007 AC
PARCEL 31	17.007 AC	17.007 AC
PARCEL 32	17.007 AC	17.007 AC
PARCEL 33	17.007 AC	17.007 AC
PARCEL 34	17.007 AC	17.007 AC
PARCEL 35	17.007 AC	17.007 AC
PARCEL 36	17.007 AC	17.007 AC
PARCEL 37	17.007 AC	17.007 AC
PARCEL 38	17.007 AC	17.007 AC
PARCEL 39	17.007 AC	17.007 AC
PARCEL 40	17.007 AC	17.007 AC
PARCEL 41	17.007 AC	17.007 AC
PARCEL 42	17.007 AC	17.007 AC
PARCEL 43	17.007 AC	17.007 AC
PARCEL 44	17.007 AC	17.007 AC
PARCEL 45	17.007 AC	17.007 AC
PARCEL 46	17.007 AC	17.007 AC
PARCEL 47	17.007 AC	17.007 AC
PARCEL 48	17.007 AC	17.007 AC
PARCEL 49	17.007 AC	17.007 AC
PARCEL 50	17.007 AC	17.007 AC

Appendix 4

Webster Pembroke Hydroelectric Facility Photos of the Project Area

Physical Address: 100-2 Main Street
Suncook, NH 03275

Webster Pembroke Impoundment

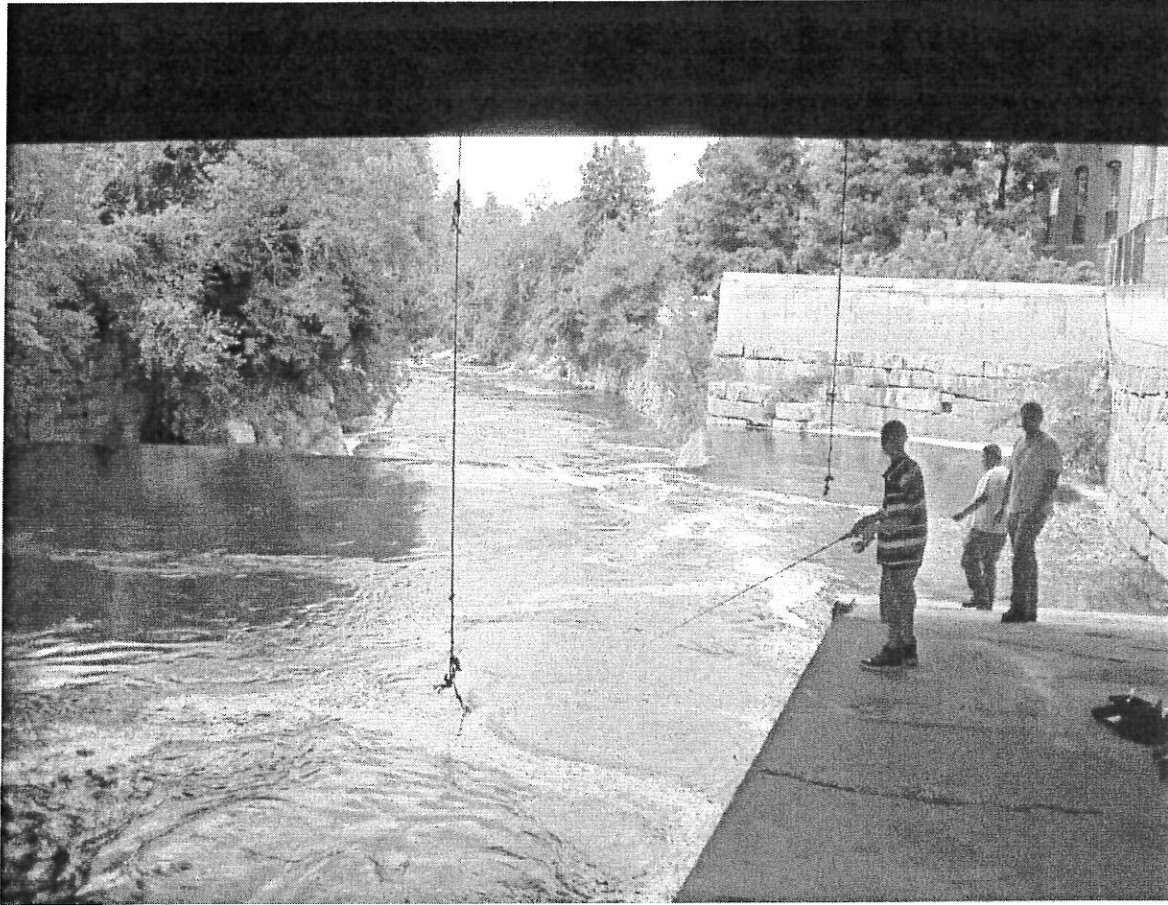

Webster Pembroke Impoundment 2

